

Third floor  
 Stratocaster  
 Suite

East facing

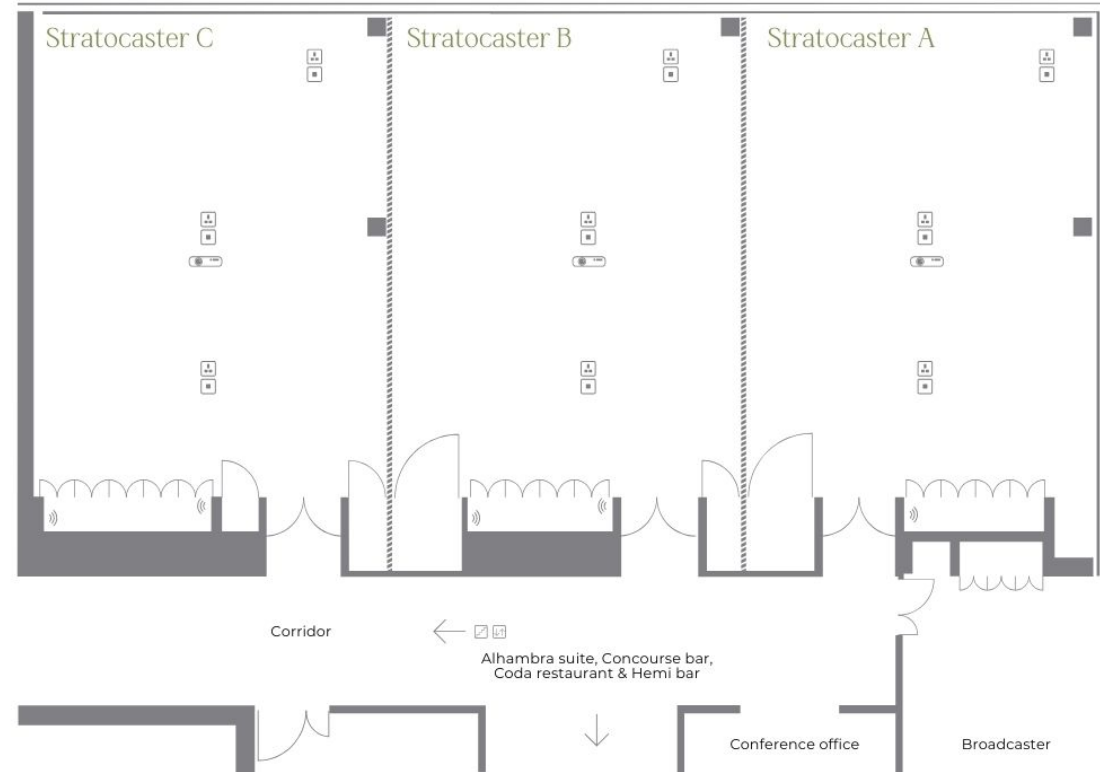

**Key**

- Projector 
- Socket 
- Data 
- Telephone 
- Wifi 
- Windows 
- Stairs 
- Lifts 

**Room details**

| Stratocaster           | Full suite   | Suite A   | Suite B   | Suite C   |
|------------------------|--|---|---|---|
| <b>Ceiling height:</b> | 5.5 x 2.7m   | 5.5m  | 5.5m  | 2.7m  |
| <b>Length:</b>         | 11.43m   | 11.43m  | 11.43m  | 11.43m  |
| <b>Width:</b>          | 23.96m   | 7.90m   | 7.90m   | 7.97m   |
| <b>Capacity:</b>       | Banquet <b>200</b><br>Boardroom <b>68</b><br>U-shape <b>77</b><br>Theatre <b>300</b><br>Classroom <b>140</b> | Banquet <b>60</b><br>Boardroom <b>28</b><br>U-shape <b>32</b><br>Theatre <b>92</b><br>Classroom <b>45</b> | Banquet <b>60</b><br>Boardroom <b>28</b><br>U-shape <b>32</b><br>Theatre <b>92</b><br>Classroom <b>45</b> | Banquet <b>60</b><br>Boardroom <b>28</b><br>U-shape <b>32</b><br>Theatre <b>92</b><br>Classroom <b>45</b> |



the gibson hotel at the point village, dublin  
 1, ireland tel: +353 (0)1 681 5000 fax: +353 (0)1  
 681 5051 www.thegibsonhotel.ie

**Third floor**

# Broadcaster Alhambra A&B

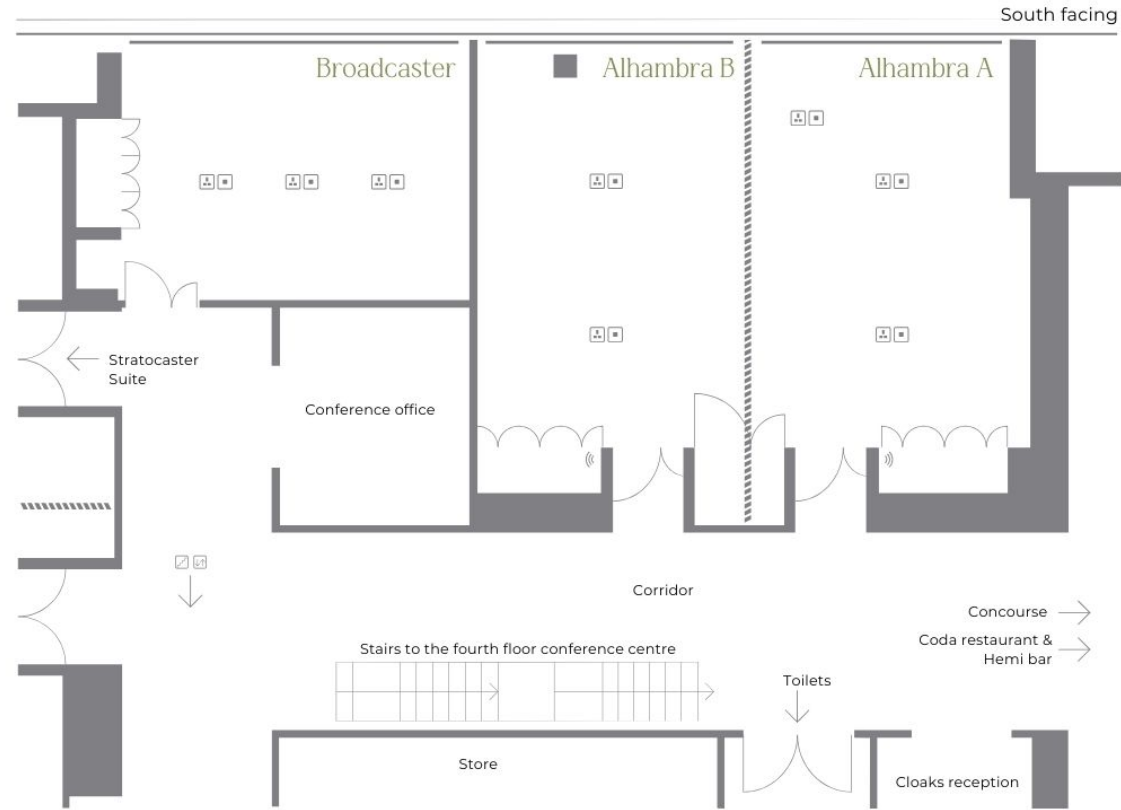

### Key

- Projector 
- Socket 
- Data 
- Telephone 
- Wifi 
- Windows 
- Stairs 
- Lifts 

### Room details

|                        | Broadcaster  | Alhambra A  | Alhambra B  | Alhambra Full Suite   |
|------------------------|--|---|---|---|
| <b>Ceiling height:</b> | 2.7m   | 2.7m  | 2.7m  | 2.7m  |
| <b>Length:</b>         | 6.10m  | 7.20m   | 7.20m   | 7.2m  |
| <b>Width:</b>          | 4.58m  | 4.90m   | 4.69m   | 9.69m   |
| <b>Capacity</b>        | Boardroom <b>14</b><br>Private dining <b>10</b><br>Classroom <b>NA</b> | Banquet <b>20</b><br>Boardroom <b>16</b><br>U-shape <b>16</b><br>Theatre <b>30</b><br>Classroom <b>15</b> | Banquet <b>20</b><br>Boardroom <b>16</b><br>U-shape <b>16</b><br>Theatre <b>30</b><br>Classroom <b>15</b> | Banquet <b>50</b><br>Boardroom <b>22</b><br>U-shape <b>27</b><br>Theatre <b>72</b><br>Classroom <b>35</b> |



the gibson hotel at the point village, dublin  
1, ireland tel: +353 (0)1 681 5000 fax: +353 (0)1  
681 5051 www.thegibsonhotel.ie

Fourth floor

# Rickenbacker Cordoba A&B

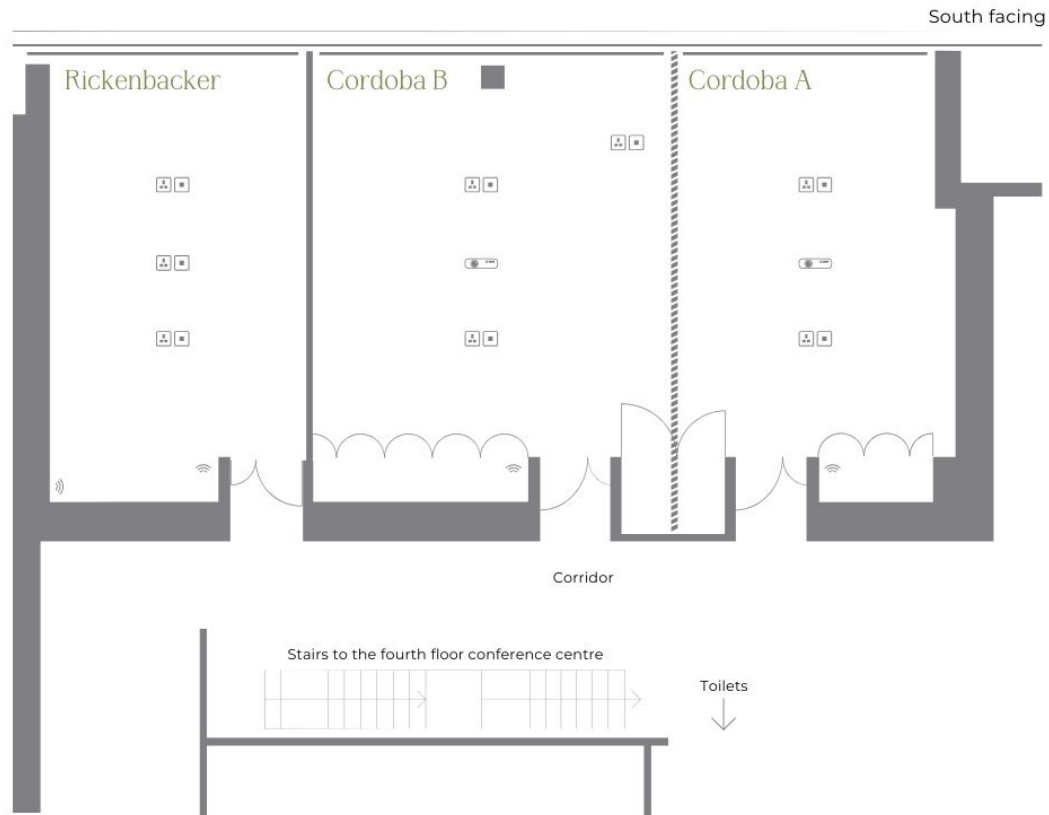

the gibson hotel at the point village, dublin  
 1, ireland tel: +353 (0)1 681 5000 fax: +353 (0)1  
 681 5051 www.thegibsonhotel.ie

### Key

- Projector 
- Socket 
- Data 
- Telephone 
- Wifi 
- Windows 
- Stairs 
- Lifts 

### Room details

|                        | Rickenbacker  | Cordoba A   | Cordoba B   | Cordoba Full Suite  |
|------------------------|---|---|---|---|
| <b>Ceiling height:</b> | 2.7m  | 2.7m  | 2.7m  | 2.7m  |
| <b>Length:</b>         | 7.12m   | 7.12m   | 7.12m   | 7.12m   |
| <b>Width:</b>          | 4.54m   | 6.31m   | 4.77m   | 11.18m  |
| <b>Capacity</b>        | Banquet <b>20</b><br>Boardroom <b>16</b><br>U-shape <b>16</b><br>Theatre <b>26</b><br>Classroom <b>12</b> | Banquet <b>20</b><br>Boardroom <b>16</b><br>U-shape <b>17</b><br>Theatre <b>38</b><br>Classroom <b>20</b> | Banquet <b>20</b><br>Boardroom <b>16</b><br>U-shape <b>16</b><br>Theatre <b>26</b><br>Classroom <b>16</b> | Banquet <b>55</b><br>Boardroom <b>28</b><br>U-shape <b>29</b><br>Theatre <b>82</b><br>Classroom <b>40</b> |